

SSM P/N SL690525

1 A2906/A2908

RELEASED 01-11-18

LET.	REVISIONS	BY/DATE	APPV. BY
A	INITIAL RELEASE PER ECN M105654.	J.S. 10-10-17	E.S. 01-09-18

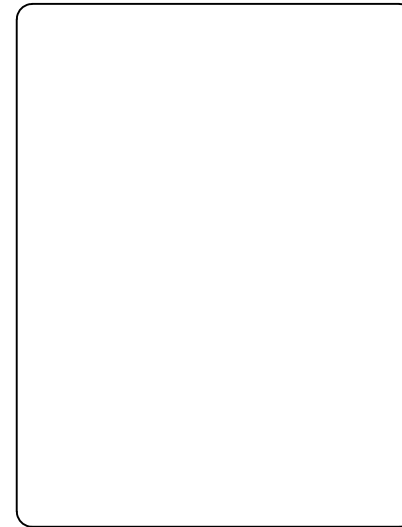
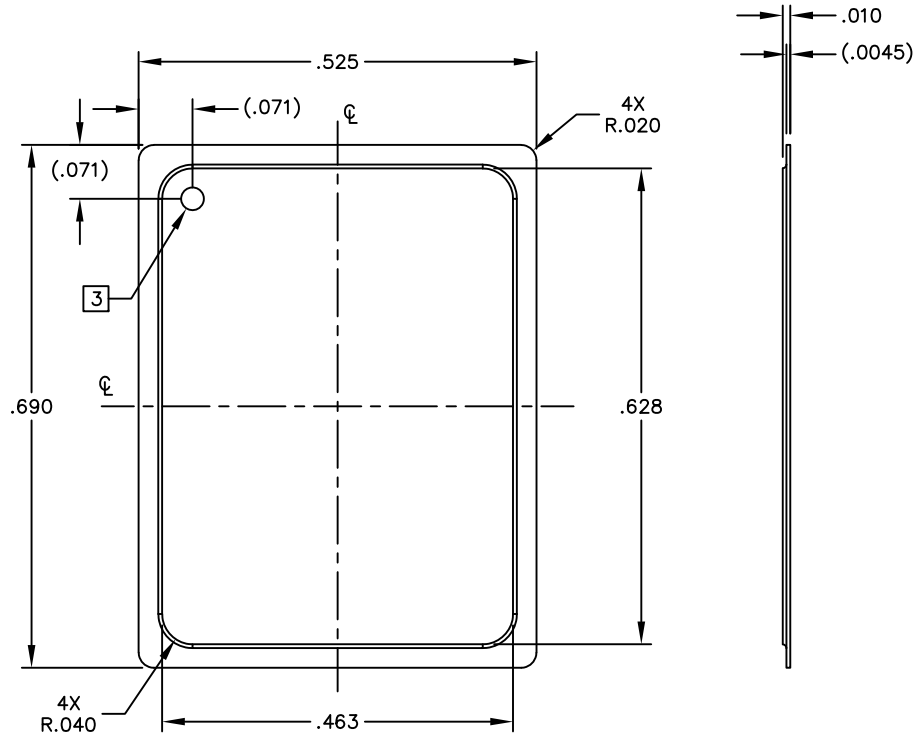

- NOTES:
1. PLATING: SEE CHART.
 2. RACK MARKS ALLOWED ON EDGES UP TO .020"
 3. ϕ .030 ID MARK (HALF ETCHED) DEPTH: (.0055)

P002	100-300 μ " ELECTROLYTIC Ni.
P001	50 μ " Au OVER 100-300 μ " ELECTROLYTIC Ni.
PART NO.	DESCRIPTION

ITEM NO.	DESCRIPTION	MATERIAL	REQ'D.	DRAWING NO.
1	LID	ASTM F-15	1	16615
BILL OF MATERIALS				

TOLERANCE UNLESS SPECIFIED .001 ± .002 ± .005 .0005 ± ANGLES ±	DRAWN BY J.SERNA	 COMPANY CONFIDENTIAL SAN DIEGO PLANT KYOCERA AMERICA INC. 8611 BALBOA AVENUE SAN DIEGO, CA 92123-1580	NAME PLATED LID
	DATE 10-10-17		MATERIAL SEE BOM
	CHECKED BY M.SHANE		PROJECT SMD 2.0
	DATE 01-11-18		DWG. NO. SD-570-A3112
DIMS. ARE IN INCHES SCALE 1X	APPROVED BY E.SUEYOSHI	REV. A	DR. N: SHEET 1 OF 1
DO NOT SCALE PRINT	DATE 01-09-18		

