

SSM P/N CLX139601

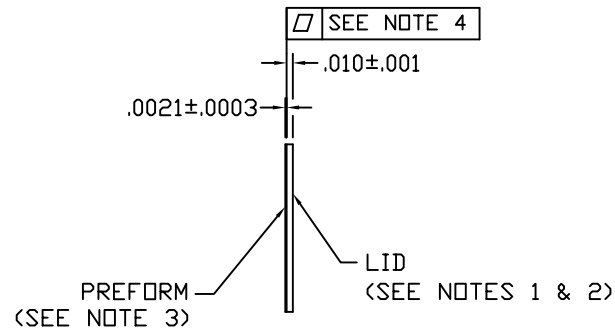
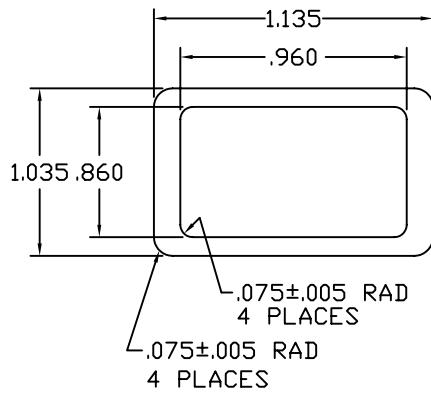

NOTES

1. MAT'L : KOVAR OR ALLOY 42
 2. PLATING : 1st LAYER 50/350 MICROINCHES NI
2nd LAYER Au
3rd LAYER 50/350 MICROINCHES NI
4th LAYER 25 MICROINCHES MINIMUM Au
- NOTES : TOTAL NICKEL LAYERS SHALL NOT EXCEED 450 MICROINCHES AND THE SUM OF BOTH GOLD LAYERS SHALL BE 50 MICROINCHES MINIMUM.
3. PREFORM - 80% $\pm 1\%$ Au
20% Sn
 4. FLATNESS : ONE MIL (.001) MAXIMUM PER 1/2" T.I.R
 5. TOLERANCES TO BE (XXX) 3 PLACES $\pm .003$ UNLESS OTHERWISE NOTED

DESCRIPTION	DRAWING NO.
Combo Lid	W967

