

SSM P/N CL463701

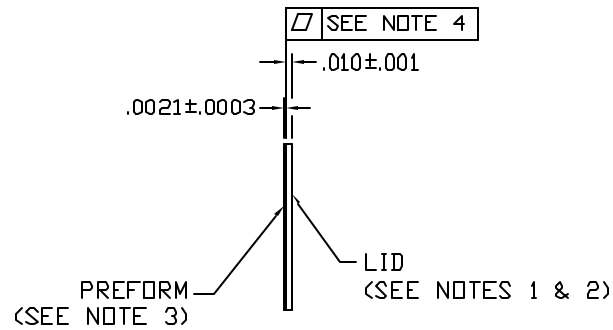
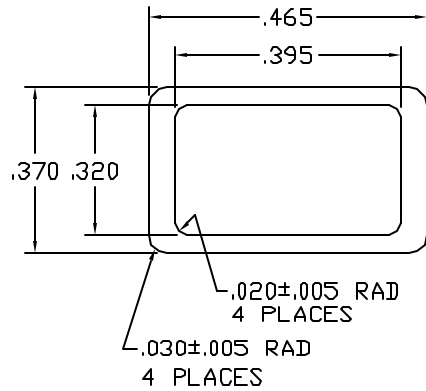

NOTES

1. MAT'L : KOVAR OR ALLOY 42
2. PLATING : 1st LAYER 50/350 MICROINCHES NI
 2nd LAYER Au
 3rd LAYER 50/350 MICROINCHES NI
 4th LAYER 25 MICROINCHES MINIMUM Au

NOTES : TOTAL NICKEL LAYERS SHALL NOT EXCEED 450 MICROINCHES AND THE SUM OF BOTH GOLD LAYERS SHALL BE 50 MICROINCHES MINIMUM.

3. PREFORM - 80% \pm 1% Au
 20% Sn
4. FLATNESS : ONE MIL (.001) MAXIMUM PER 1/2" T.I.R
5. TOLERANCES TO BE (XXX) 3 PLACES \pm .003 UNLESS OTHERWISE NOTED

DESCRIPTION	HI-Rel Combo Lid
MFG DRAWING NO.	W642H

